

AENC-MMAC-ENG-DWG-0083

# Norwich to Tilbury

## Volume 2: Plans, Drawings and Sections

Document: 2.4 Traffic Regulation Order Plans - Section D

Final Issue A

August 2025

Planning Inspectorate Reference: EN020027

Infrastructure Planning (Applications: Prescribed Forms and Procedure) Regulations 2009 Regulation 5(2)(o)

nationalgrid



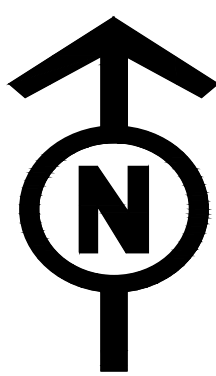

THE NATIONAL GRID (NORWICH TO TILBURY) ORDER  
TRAFFIC REGULATION ORDER PLANS KEY PLAN  
REGULATION 5(2)(o)  
SECTION D (SHEET 1 OF 1,  
BRAINTREE DISTRICT COUNCIL, COLCHESTER CITY COUNCIL AND TENDRING DISTRICT COUNCIL)

Application Document 2.4

SITE MAP

**Legend**  
--- Local authority boundary  
--- Section boundary & local authority boundary  
--- Section boundary  
--- Sheet index  
--- Order Limits

**Notes**  
1. These plans show the Order Limits and potential location for the works. Due to the need for future flexibility, National Grid will be applying for Order Limits and Limits of Deviation within its Development Consent Order, within which any final alignment would lie.  
2. For additional detail on the plan suites, please refer to the Guide to Plans (document reference 2.0), located in the Volume 2 of the DCO application.  
3. This drawing is scaled at paper size A0, therefore any prints taken at smaller sizes will affect accuracy of the measurement units and should not be scaled against.

Coordinate System: British National Grid  
Sheet X Centroid Coordinate: 594955 Sheet Y Centroid Coordinate: 227102  
0 250 500 1,000 1,500 Meters

BACKGROUND MAPPING INFORMATION HAS BEEN REPRODUCED FROM THE ORDNANCE SURVEY BY PERMISSION OF ORDNANCE SURVEY OF THE CONTROLLER OF HIS MAJESTY'S STATIONERY OFFICE. © CROWN COPYRIGHT AND DATABASE RIGHTS (2025) LICENCE OS100024241 AND AC0000807948.

A	AUG-2025	For DCO submission	TC	ST	KR
Issue	Date	Remarks	Drawn	Checked	Approved

THE NATIONAL GRID  
(NORWICH TO TILBURY) ORDER  
TRAFFIC REGULATION ORDER PLANS KEY PLAN  
REGULATION 5(2)(o)  
SECTION D (SHEET 1 OF 1,  
BRAINTREE DISTRICT COUNCIL,  
COLCHESTER CITY COUNCIL AND  
TENDRING DISTRICT COUNCIL)

**nationalgrid**

PIINS Application Number EN020027

National Grid Drawing Reference  
AENC-MMAC-ENG-DWG-0083

Scale	Sheet Size	Sheet	Issue
1:17,000	A0	SHEET 1 OF 1	A

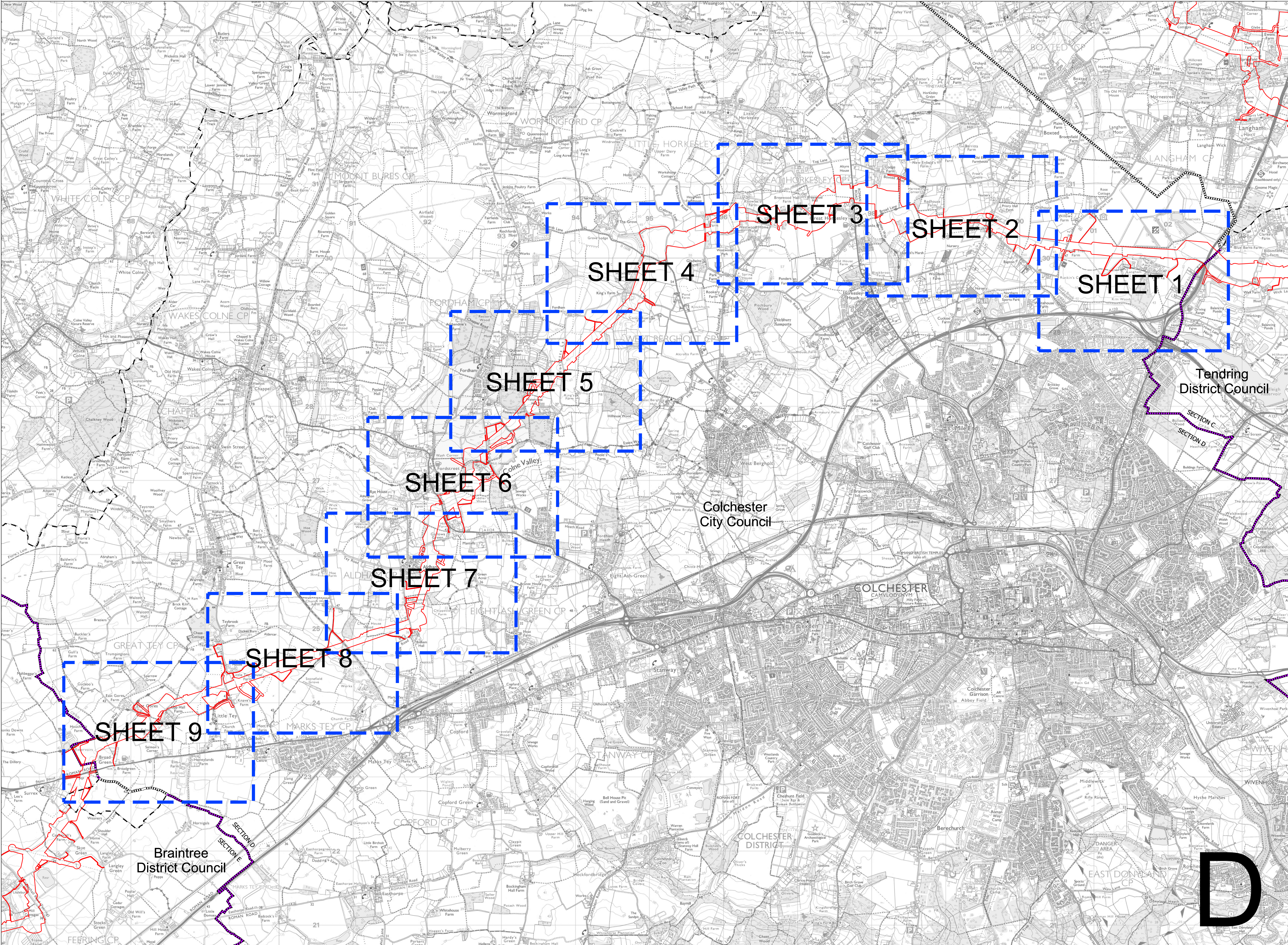



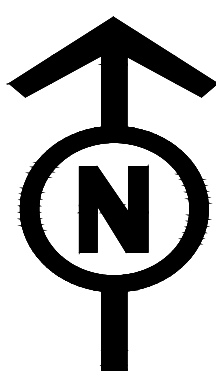

THE NATIONAL GRID (NORWICH TO TILBURY) ORDER  
TRAFFIC REGULATION ORDER PLANS  
REGULATION 5(2)(o)  
SECTION D (SHEET 1 OF 9,  
COLCHESTER CITY COUNCIL AND TENDRING DISTRICT COUNCIL)

Application Document 2.4

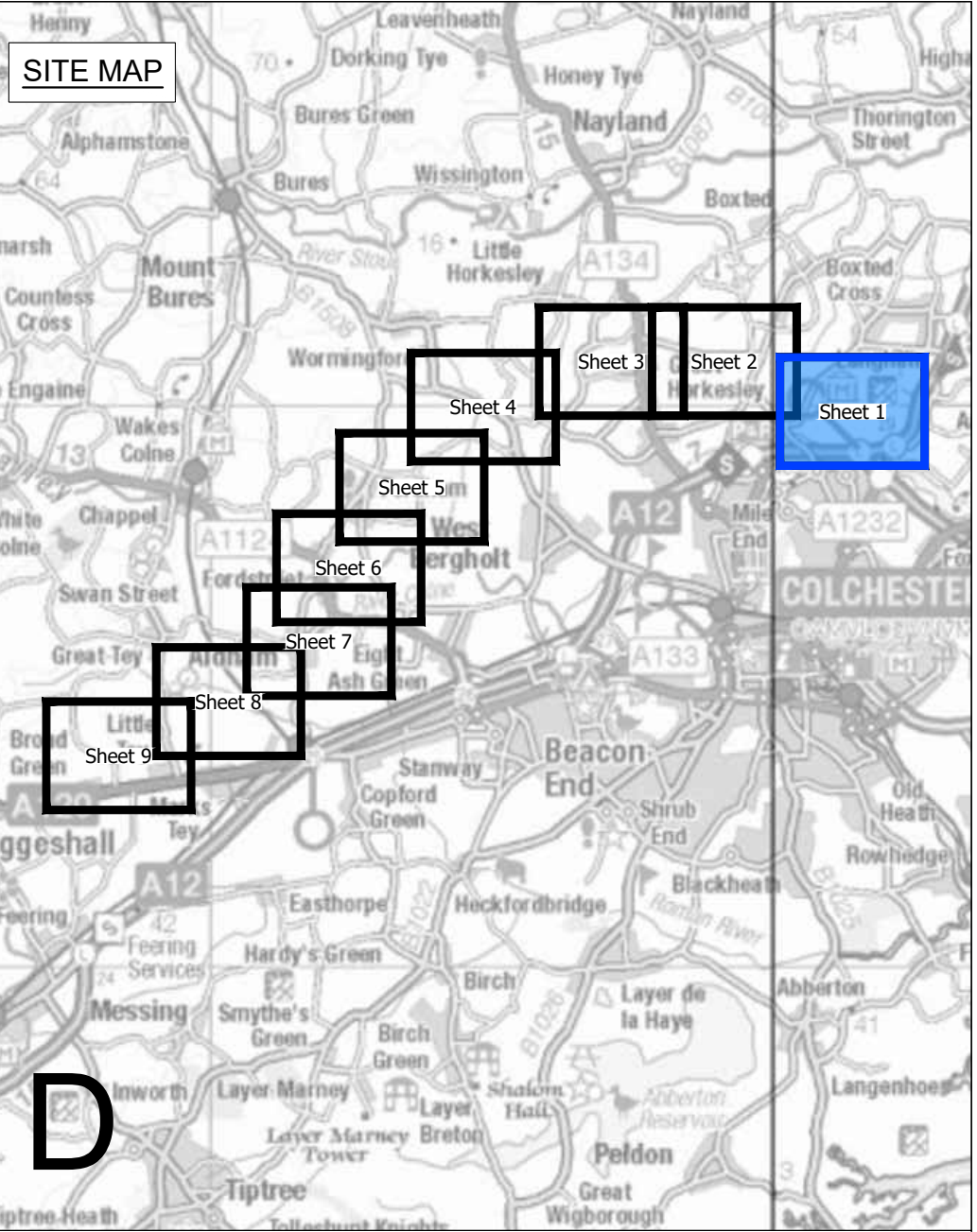

**D**

**Legend**

- Local authority boundary
- Section boundary & local authority boundary
- Section boundary
- Sheet index cutlines
- Order Limits

**Street Works**

- Street management: start/end point of traffic regulation order
- Street management: Temporary traffic regulation order
- Street management: Permanent traffic regulation order
- Example reference for traffic regulation order

**Notes**

1. These plans show the Order Limits and potential location for the works. Due to the need for future flexibility, National Grid will be applying for Order Limits and Limits of Deviation within its Development Consent Order, within which any final alignment would lie.

2. For additional detail on the plan suites, please refer to the Guide to Plans (document reference 2.0), located in the Volume 2 of the DCO application.

3. This drawing is scaled at paper size A0, therefore any prints taken at smaller sizes will affect accuracy of the measurement units and should not be scaled against.

4. These plans should be read in conjunction with Parts 1 to 4 of Schedule 13 (Traffic Regulation Orders) of the Development Consent Order.

Coordinate System: British National Grid  
Sheet X Centroid Coordinate: 601536 Sheet Y Centroid Coordinate: 229701

0 50 100 200 250 Metres

BACKGROUND MAPPING INFORMATION HAS BEEN REPRODUCED FROM THE ORDNANCE SURVEY BY PERMISSION OF ORDNANCE SURVEY OF THE CONTROLLER OF HIS MAJESTY'S STATIONERY OFFICE. © CROWN COPYRIGHT AND DATABASE RIGHTS (2025) LICENCE OS100024241 AND AC0000807948.

A	AUG-2025	For DCO submission	MC	DC	KR
Issue	Date	Remarks	Drawn	Checked	Approved
Title					
THE NATIONAL GRID (NORWICH TO TILBURY) ORDER TRAFFIC REGULATION ORDER PLANS REGULATION 5(2)(o) SECTION D (SHEET 1 OF 9, COLCHESTER CITY COUNCIL AND TENDRING DISTRICT COUNCIL)					

**nationalgrid**

<u>PINS Application Number</u>		EN020027	
<u>National Grid Drawing Reference</u>			
AENC-MMAC-ENG-DWG-0083			
<u>Scale</u>	<u>Sheet Size</u>	<u>Sheet</u>	<u>Issue</u>
1:2,500	A0	SHEET 1 OF 9	A

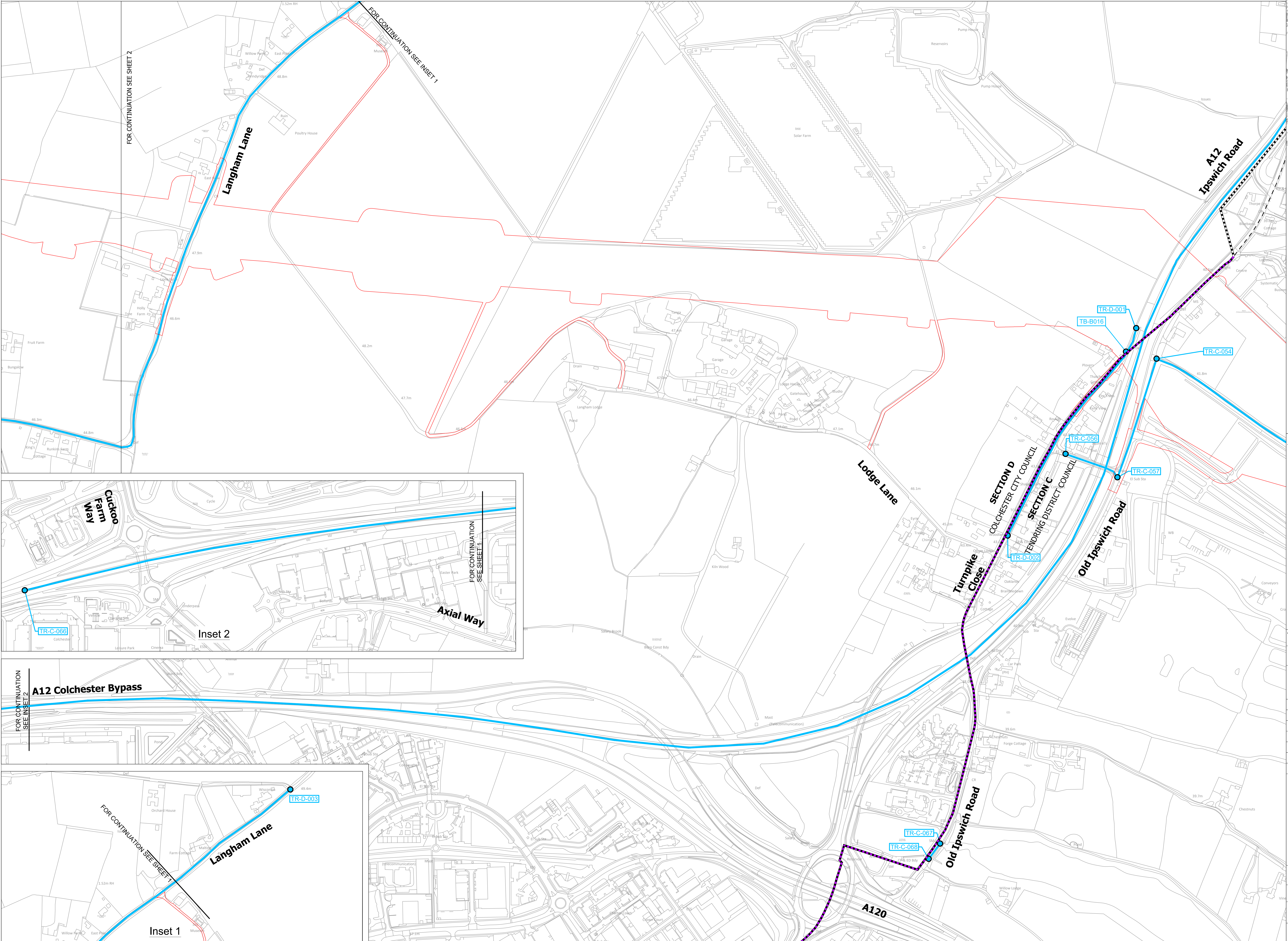



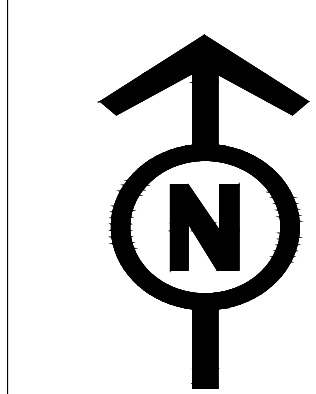

THE NATIONAL GRID (NORWICH TO TILBURY) ORDER  
TRAFFIC REGULATION ORDER PLANS  
REGULATION 5(2)(o)  
SECTION D (SHEET 2 OF 9,  
COLCHESTER CITY COUNCIL)

Application Document 2.4

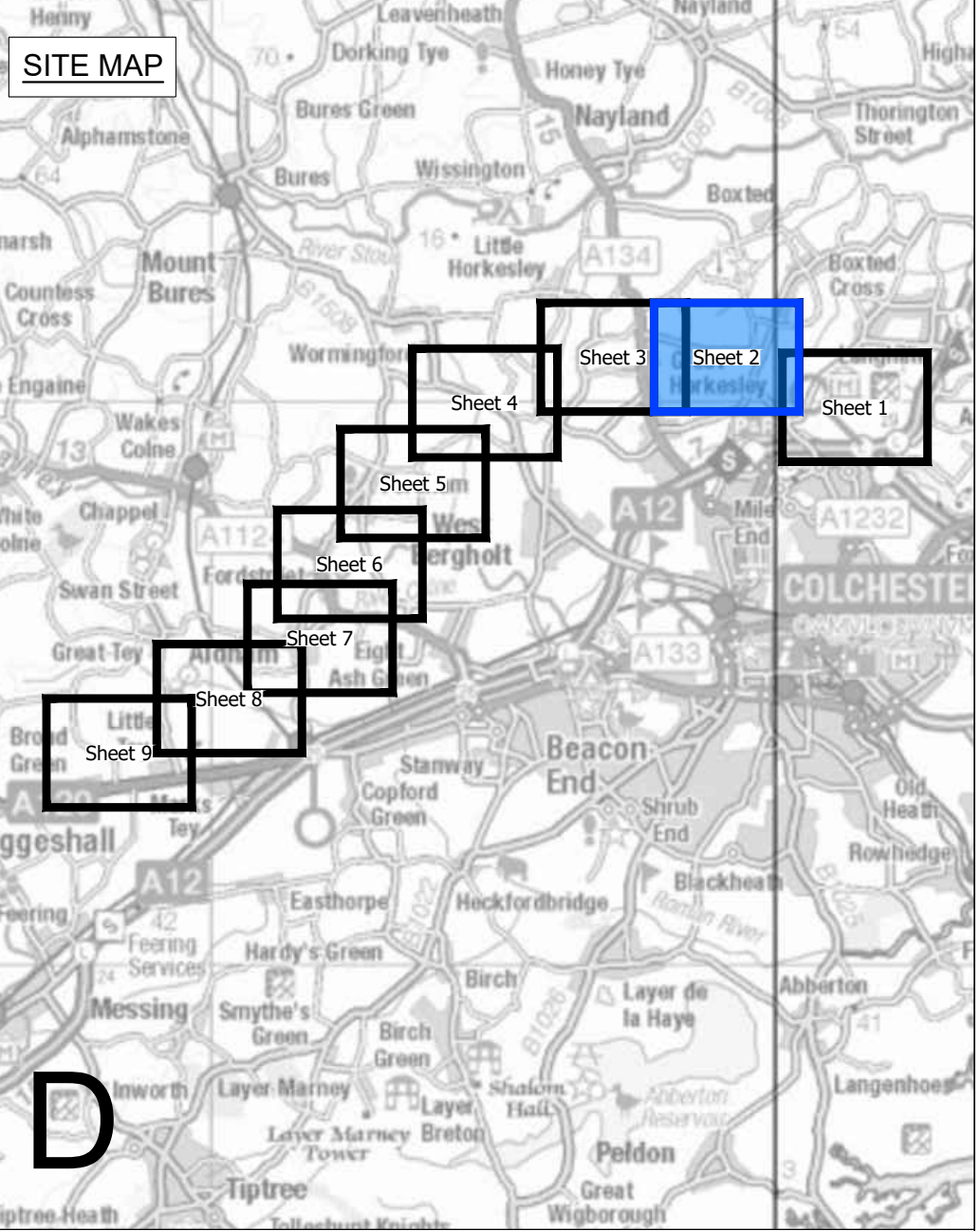

- Legend**
- Local authority boundary
  - Section boundary & local authority boundary
  - Section boundary
  - Sheet index cutlines
  - Order Limits
- Street Works**
- Street management: start/end point of traffic regulation order
  - Street management: Temporary traffic regulation order
  - Street management: Permanent traffic regulation order
- Example reference for traffic regulation order

- Notes**
- These plans show the Order Limits and potential location for the works. Due to the need for future flexibility, National Grid will be applying for Order Limits and Limits of Deviation within its Development Consent Order, within which any final alignment would lie.
  - For additional detail on the plan suites, please refer to the Guide to Plans (document reference 2.0), located in the Volume 2 of the DCO application.
  - This drawing is scaled at paper size A0, therefore any prints taken at smaller sizes will affect accuracy of the measurement units and should not be scaled against.
  - These plans should be read in conjunction with Parts 1 to 4 of Schedule 13 (Traffic Regulation Orders) of the Development Consent Order.

Coordinate System: British National Grid  
Sheet X Centroid Coordinate: 598215 Sheet Y Centroid Coordinate: 230440  
0 50 100 150 200 250 Metres  
BACKGROUND MAPPING INFORMATION HAS BEEN REPRODUCED FROM THE ORDNANCE SURVEY BY PERMISSION OF ORDNANCE SURVEY OF THE CONTROLLER OF HIS MAJESTY'S STATIONERY OFFICE. © CROWN COPYRIGHT AND DATABASE RIGHTS (2025) LICENCE OS100024241 AND AC0000807948.

A	AUG-2025	For DCO submission	MC	DC	KR
Issue	Date	Remarks	Drawn	Checked	Approved

THE NATIONAL GRID  
(NORWICH TO TILBURY) ORDER  
TRAFFIC REGULATION ORDER PLANS  
REGULATION 5(2)(o)  
SECTION D (SHEET 2 OF 9,  
COLCHESTER CITY COUNCIL)

**nationalgrid**

PINS Application Number EN020027

National Grid Drawing Reference  
AENC-MMAC-ENG-DWG-0083

Scale	Sheet Size	Sheet	Issue
1:2,500	A0	SHEET 2 OF 9	A



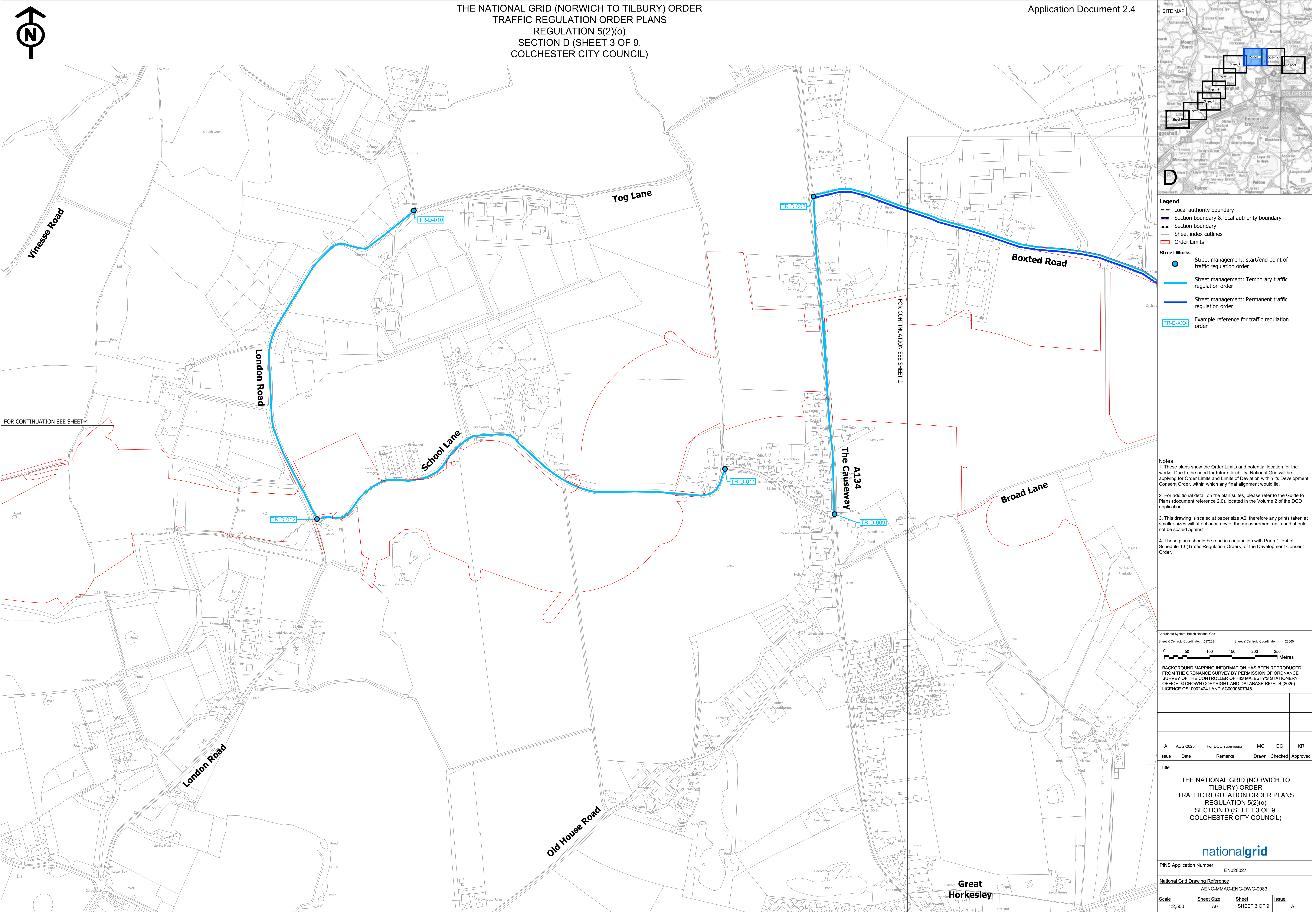



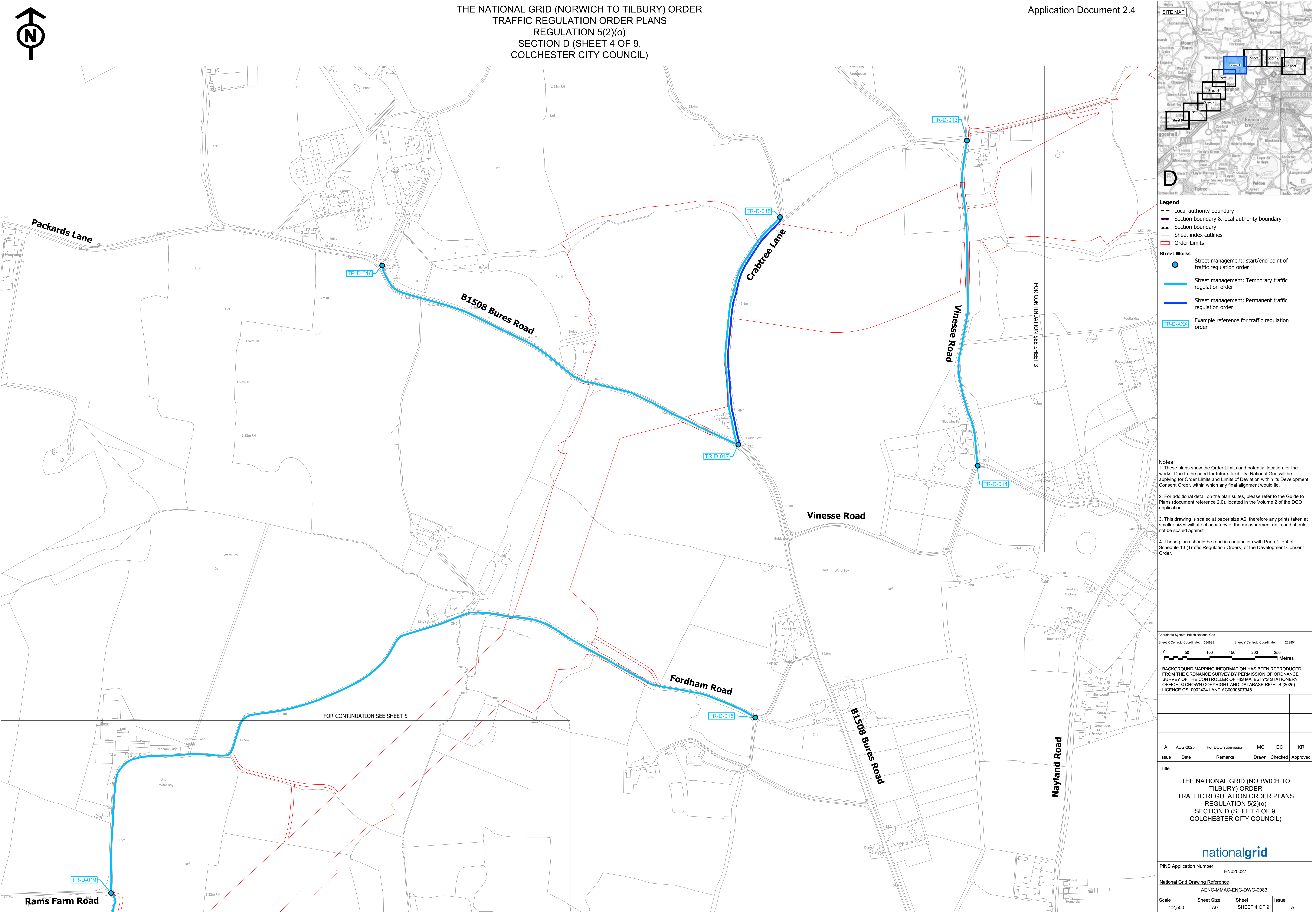



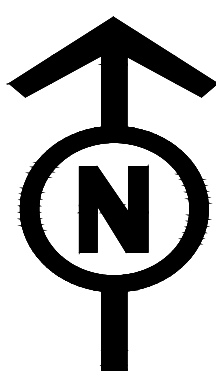

THE NATIONAL GRID (NORWICH TO TILBURY) ORDER  
TRAFFIC REGULATION ORDER PLANS  
REGULATION 5(2)(o)  
SECTION D (SHEET 5 OF 9,  
COLCHESTER CITY COUNCIL)

Application Document 2.4

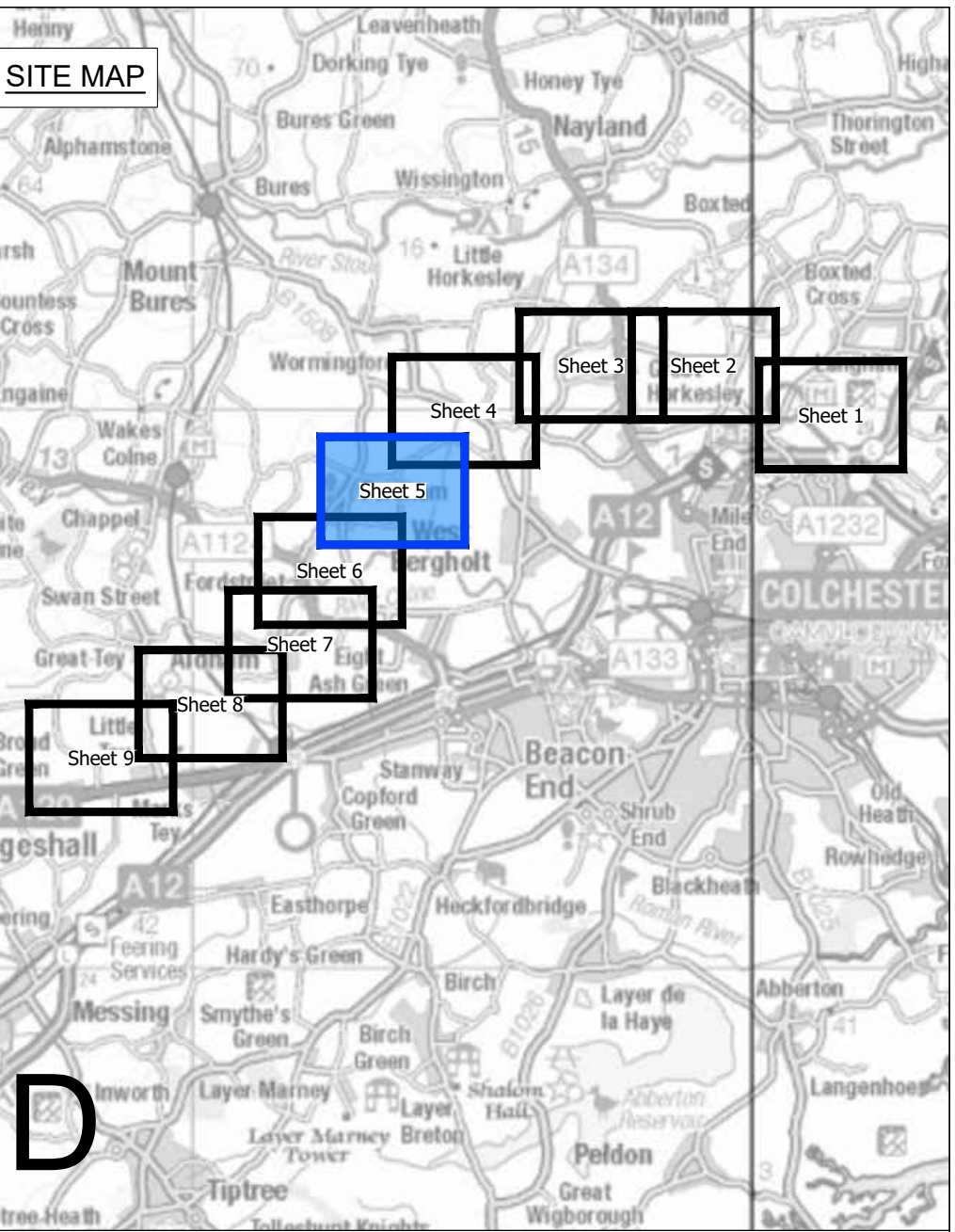

- Legend**
- Local authority boundary
  - Section boundary & local authority boundary
  - Section boundary
  - Sheet index cutlines
  - Order Limits
- Street Works**
- Street management: start/end point of traffic regulation order
  - Street management: Temporary traffic regulation order
  - Street management: Permanent traffic regulation order
  - Example reference for traffic regulation order

- Notes**
- These plans show the Order Limits and potential location for the works. Due to the need for future flexibility, National Grid will be applying for Order Limits and Limits of Deviation within its Development Consent Order, within which any final alignment would lie.
  - For additional detail on the plan suites, please refer to the Guide to Plans (document reference 2.0), located in the Volume 2 of the DCO application.
  - This drawing is scaled at paper size A0, therefore any prints taken at smaller sizes will affect accuracy of the measurement units and should not be scaled against.
  - These plans should be read in conjunction with Parts 1 to 4 of Schedule 13 (Traffic Regulation Orders) of the Development Consent Order.

Coordinate System: British National Grid  
Sheet X Centroid Coordinate: 585999 Sheet Y Centroid Coordinate: 228447  
0 50 100 150 200 250 Metres  
BACKGROUND MAPPING INFORMATION HAS BEEN REPRODUCED FROM THE ORDNANCE SURVEY BY PERMISSION OF ORDNANCE SURVEY OF THE CONTROLLER OF HIS MAJESTY'S STATIONERY OFFICE. © CROWN COPYRIGHT AND DATABASE RIGHTS (2025) LICENCE OS100024241 AND AC0000807948.

A	AUG-2025	For DCO submission	MC	DC	KR
Issue	Date	Remarks	Drawn	Checked	Approved

THE NATIONAL GRID (NORWICH TO TILBURY) ORDER  
TRAFFIC REGULATION ORDER PLANS  
REGULATION 5(2)(o)  
SECTION D (SHEET 5 OF 9,  
COLCHESTER CITY COUNCIL)

**nationalgrid**

PIINS Application Number EN020027

National Grid Drawing Reference  
AENC-MMAC-ENG-DWG-0083

Scale	Sheet Size	Sheet	Issue
1:2,500	A0	SHEET 5 OF 9	A



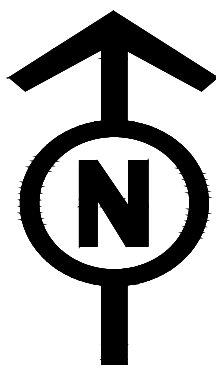

THE NATIONAL GRID (NORWICH TO TILBURY) ORDER  
TRAFFIC REGULATION ORDER PLANS  
REGULATION 5(2)(o)  
SECTION D (SHEET 6 OF 9,  
COLCHESTER CITY COUNCIL)

Application Document 2.4

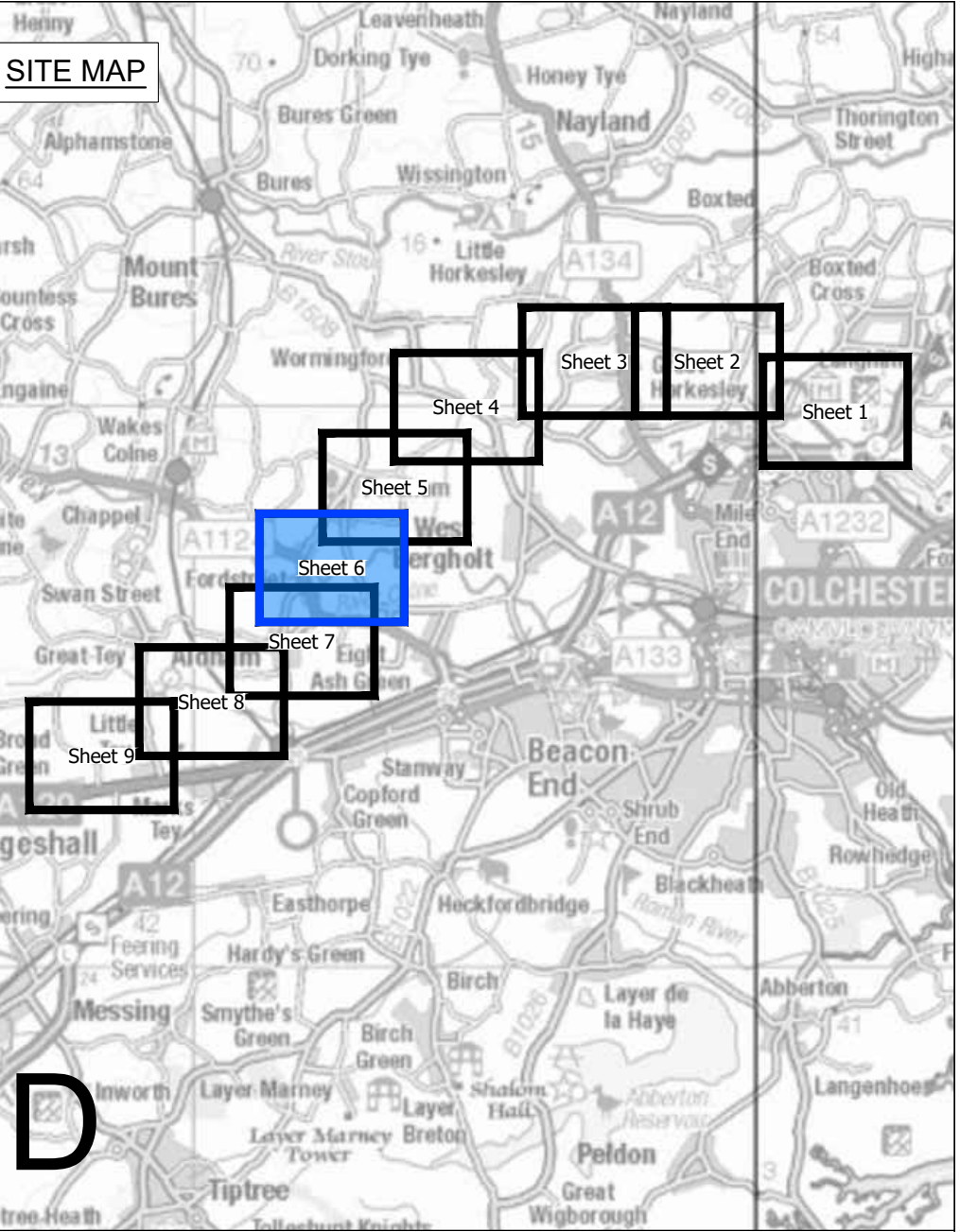

**Legend**

- Local authority boundary
- Section boundary & local authority boundary
- Section boundary
- Sheet index cutlines
- Order Limits

**Street Works**

- Street management: start/end point of traffic regulation order
- Street management: Temporary traffic regulation order
- Street management: Permanent traffic regulation order
- Example reference for traffic regulation order

**Notes**

1. These plans show the Order Limits and potential location for the works. Due to the need for future flexibility, National Grid will be applying for Order Limits and Limits of Deviation within its Development Consent Order, within which any final alignment would lie.

2. For additional detail on the plan suites, please refer to the Guide to Plans (document reference 2.0), located in the Volume 2 of the DCO application.

3. This drawing is scaled at paper size A0, therefore any prints taken at smaller sizes will affect accuracy of the measurement units and should not be scaled against.

4. These plans should be read in conjunction with Parts 1 to 4 of Schedule 13 (Traffic Regulation Orders) of the Development Consent Order.

Coordinate System: British National Grid  
Sheet X Centroid Coordinate: 592481  
Sheet Y Centroid Coordinate: 226917

0 50 100 150 200 250 Metres

BACKGROUND MAPPING INFORMATION HAS BEEN REPRODUCED FROM THE ORDNANCE SURVEY BY PERMISSION OF ORDNANCE SURVEY OF THE CONTROLLER OF HIS MAJESTY'S STATIONERY OFFICE. © CROWN COPYRIGHT AND DATABASE RIGHTS (2025) LICENCE OS100024241 AND AC0000807948.

Issue	Date	Remarks	Drawn	Checked	Approved
Title					

THE NATIONAL GRID (NORWICH TO TILBURY) ORDER  
TRAFFIC REGULATION ORDER PLANS  
REGULATION 5(2)(o)  
SECTION D (SHEET 6 OF 9,  
COLCHESTER CITY COUNCIL)

**nationalgrid**

PINS Application Number EN020027

National Grid Drawing Reference  
AENC-MMAC-ENG-DWG-0083

Scale	Sheet Size	Sheet	Issue
1:2,500	A0	SHEET 6 OF 9	A



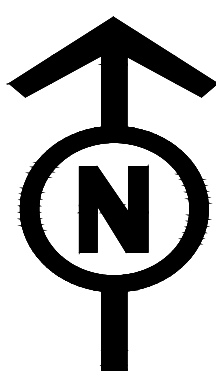

THE NATIONAL GRID (NORWICH TO TILBURY) ORDER  
TRAFFIC REGULATION ORDER PLANS  
REGULATION 5(2)(o)  
SECTION D (SHEET 7 OF 9,  
COLCHESTER CITY COUNCIL)

Application Document 2.4

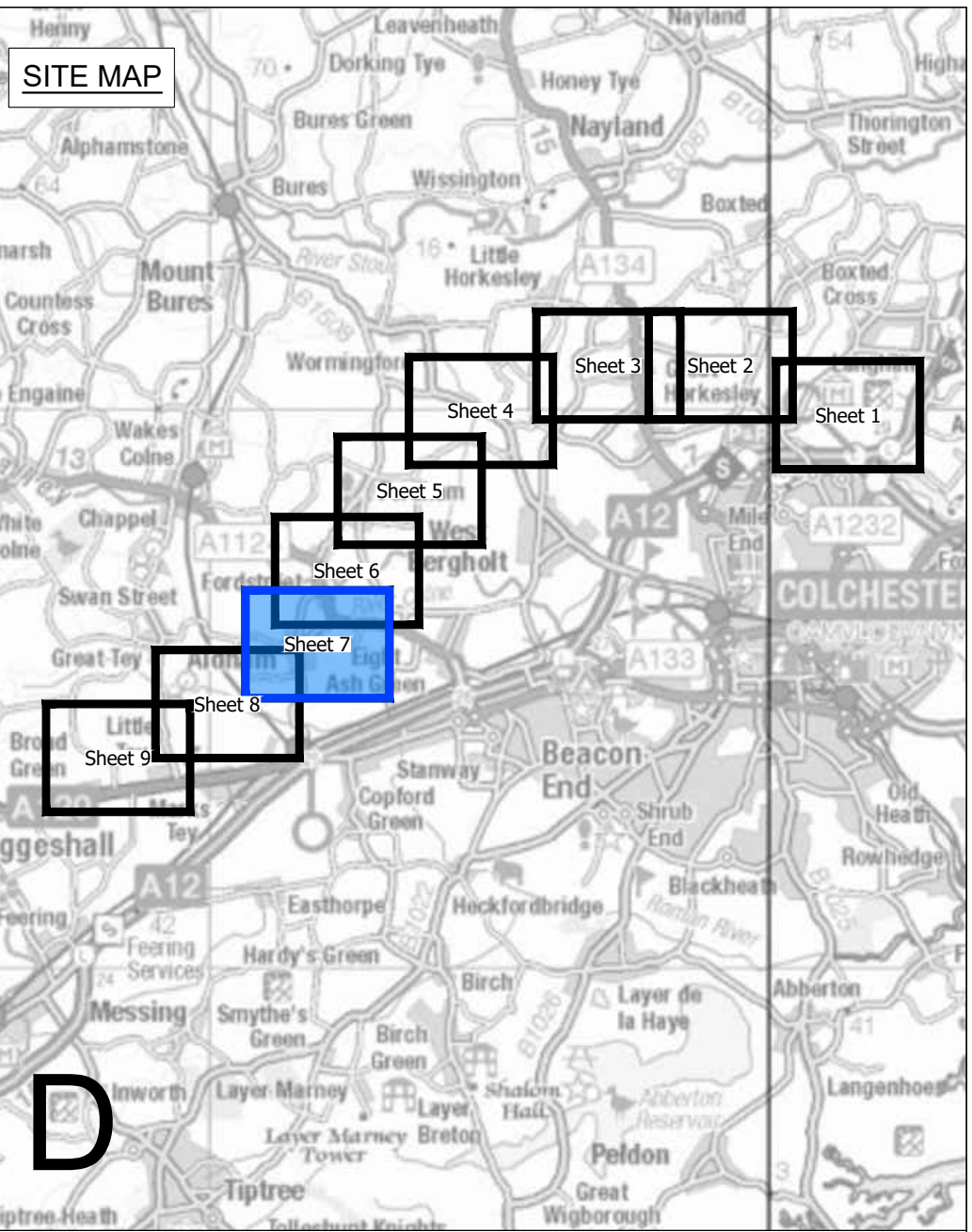

- Legend**
- Local authority boundary
  - Section boundary & local authority boundary
  - Section boundary
  - Sheet index cutlines
  - Order Limits
- Street Works**
- Street management: start/end point of traffic regulation order
  - Street management: Temporary traffic regulation order
  - Street management: Permanent traffic regulation order
  - Example reference for traffic regulation order

- Notes**
- These plans show the Order Limits and potential location for the works. Due to the need for future flexibility, National Grid will be applying for Order Limits and Limits of Deviation within its Development Consent Order, within which any final alignment would lie.
  - For additional detail on the plan suites, please refer to the Guide to Plans (document reference 2.0), located in the Volume 2 of the DCO application.
  - This drawing is scaled at paper size A0, therefore any prints taken at smaller sizes will affect accuracy of the measurement units and should not be scaled against.
  - These plans should be read in conjunction with Parts 1 to 4 of Schedule 13 (Traffic Regulation Orders) of the Development Consent Order.

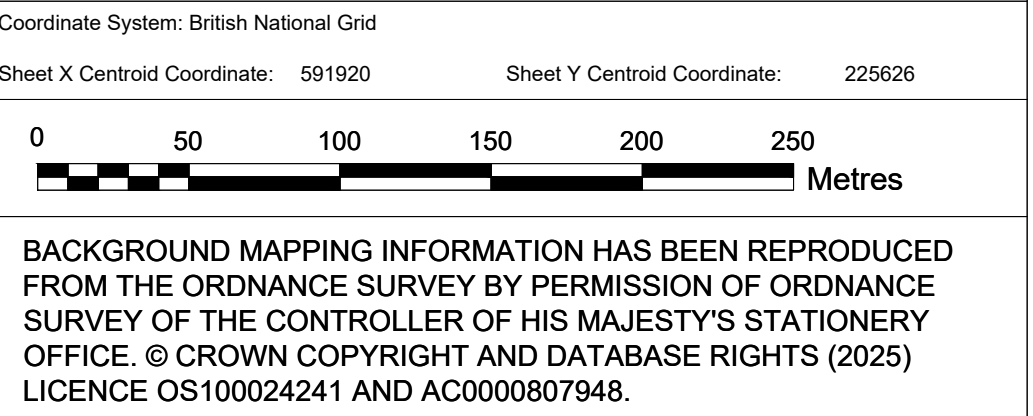

A	AUG-2025	For DCO submission	MC	DC	KR
Issue	Date	Remarks	Drawn	Checked	Approved

THE NATIONAL GRID (NORWICH TO TILBURY) ORDER  
TRAFFIC REGULATION ORDER PLANS  
REGULATION 5(2)(o)  
SECTION D (SHEET 7 OF 9,  
COLCHESTER CITY COUNCIL)

**nationalgrid**

PINS Application Number EN020027

National Grid Drawing Reference  
AENC-MMAC-ENG-DWG-0083

Scale	Sheet Size	Sheet	Issue
1:2,500	A0	SHEET 7 OF 9	A



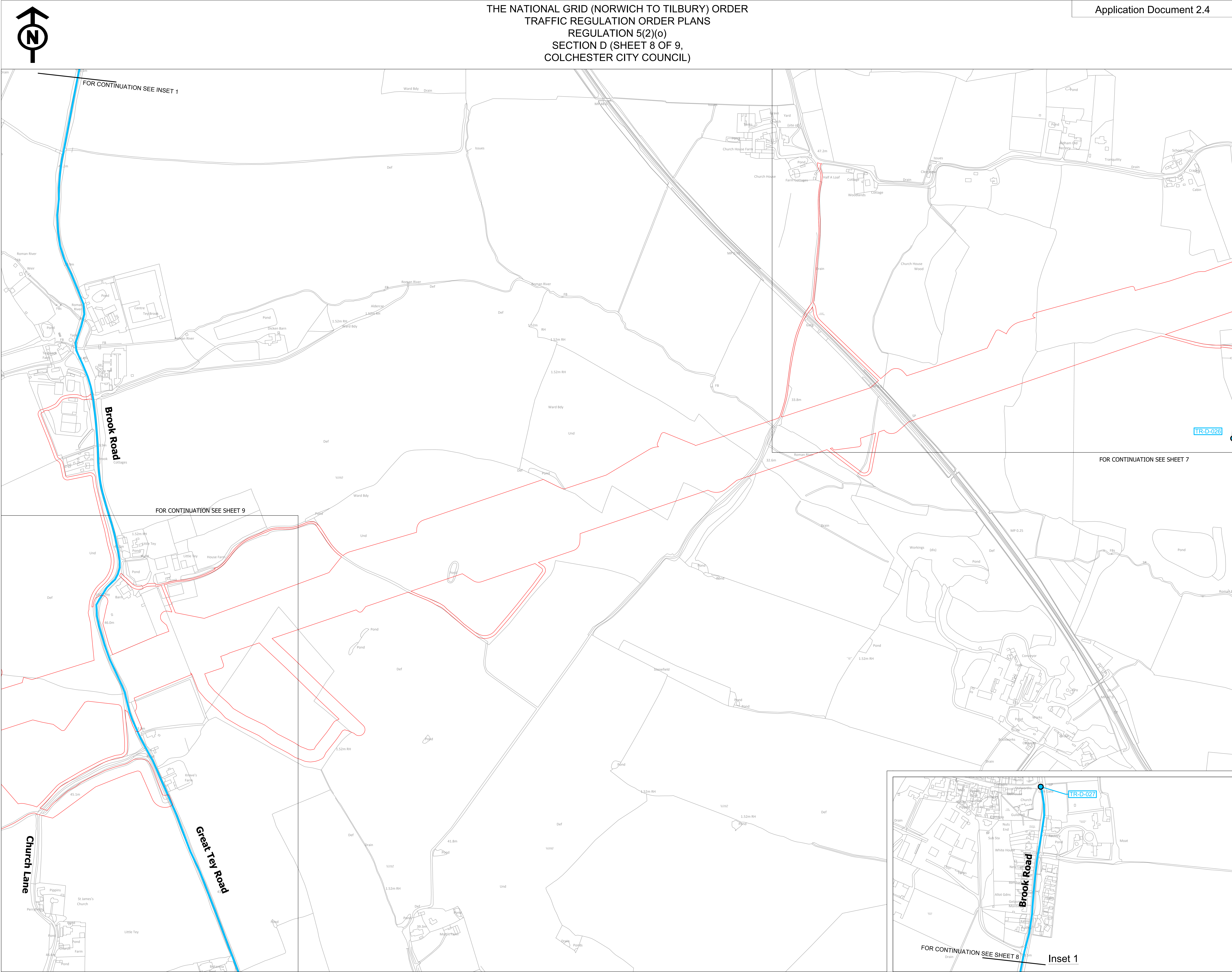

SITE MAP

Sheet 1

Sheet 2

Sheet 3

Sheet 4

Sheet 5

Sheet 6

Sheet 7

Sheet 8

Sheet 9

D

Legend

Local authority boundary

Section boundary & local authority boundary

Section boundary

Sheet index cutlines

Order Limits

Street Works

Street management: start/end point of traffic regulation order

Street management: Temporary traffic regulation order

Street management: Permanent traffic regulation order

Example reference for traffic regulation order

Notes

1. These plans show the Order Limits and potential location for the works. Due to the need for future flexibility, National Grid will be applying for Order Limits and Limits of Deviation within its Development Consent Order, within which any final alignment would lie.

2. For additional detail on the plan suites, please refer to the Guide to Plans (document reference 2.0), located in the Volume 2 of the DCO application.

3. This drawing is scaled at paper size A0, therefore any prints taken at smaller sizes will affect accuracy of the measurement units and should not be scaled against.

4. These plans should be read in conjunction with Parts 1 to 4 of Schedule 13 (Traffic Regulation Orders) of the Development Consent Order.

Coordinate System: British National Grid

Sheet X Centroid Coordinate: 590318

Sheet Y Centroid Coordinate: 224542

0

50

100

150

200

250

Metres

BACKGROUND MAPPING INFORMATION HAS BEEN REPRODUCED FROM THE ORDNANCE SURVEY BY PERMISSION OF ORDNANCE SURVEY OF THE CONTROLLER OF HIS MAJESTY'S STATIONERY OFFICE. © CROWN COPYRIGHT AND DATABASE RIGHTS (2025) LICENCE OS100024241 AND AC0000807948.

A	AUG-2025	For DCO submission	MC	DC	KR
Issue	Date	Remarks	Drawn	Checked	Approved
Title					
THE NATIONAL GRID (NORWICH TO TILBURY) ORDER TRAFFIC REGULATION ORDER PLANS REGULATION 5(2)(o) SECTION D (SHEET 8 OF 9, COLCHESTER CITY COUNCIL)					

nationalgrid

PINS Application Number

EN020027

National Grid Drawing Reference

AENC-MMAC-ENG-DWG-0083

Scale

1:2,500

Sheet Size

A0

Sheet

SHEET 8 OF 9

Issue

A

FOR CONTINUATION SEE SHEET 8

Inset 1

TR-D-027

Brook Road

Church Lane

Great Tey Road

COPYRIGHT: NOT TO BE REPRODUCED WITHOUT THE WRITTEN PERMISSION OF NATIONAL GRID ELECTRICITY TRANSMISSION Plc

COPYRIGHT: NOT TO BE REPRODUCED WITHOUT THE WRITTEN PERMISSION OF NATIONAL GRID ELECTRICITY TRANSMISSION Plc

COPYRIGHT: NOT TO BE REPRODUCED WITHOUT THE WRITTEN PERMISSION OF NATIONAL GRID ELECTRICITY TRANSMISSION Plc

COPYRIGHT: NOT TO BE REPRODUCED WITHOUT THE WRITTEN PERMISSION OF NATIONAL GRID ELECTRICITY TRANSMISSION Plc



